

RF+Bluetooth RGB+CCT Remote

09.SB2858.04841

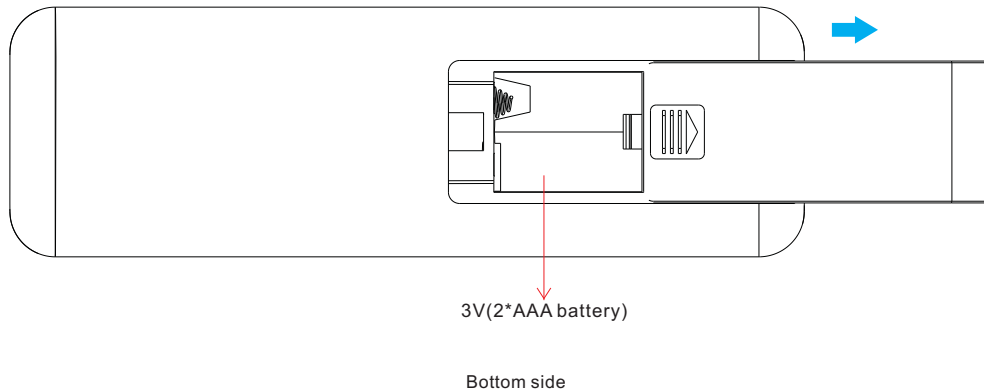

Important: Read All Instructions Prior to Installation
Function introduction

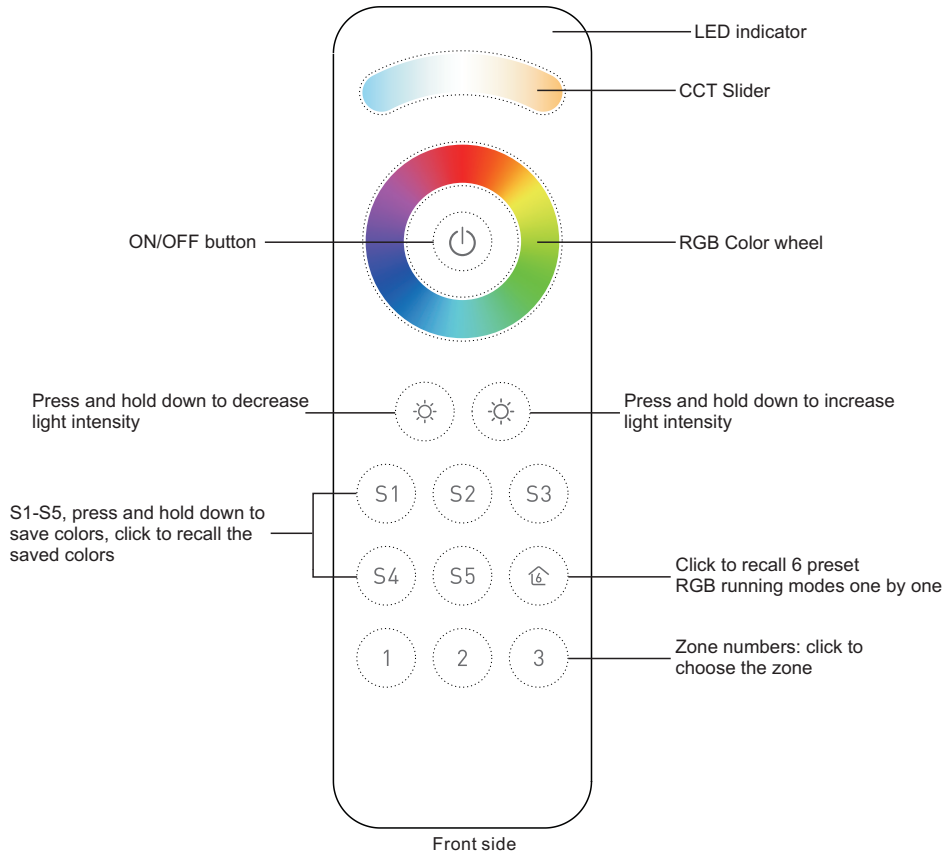

Product Data

Output	RF+Bluetooth signal
Operation Frequency	2.4GHz
Power Supply	3V(1xCR2450 battery)
Operating temperature	0-40°C
Relative humidity	8% to 80%
Dimensions	140x44x17mm

- RF+Bluetooth RGB+CCT remote
- Control 3 zones of RF+Bluetooth receiver
- RGB channels and CCT channels are controlled separately
- Enables to save and recall 5 scenes for each zone
- Easy & quick pairing to the RF+Bluetooth receivers by simply pushing the buttons
- Mesh network for further control distance, receivers can transmit signal to each other
- Each remote can control numerous receivers
- Each receiver can be paired to max. 8 remote controls
- The controlled receiver status can be quickly synchronized to the smart APP
- Transmission range between every two neighbor devices up to 30m
- Bluetooth low power consumption technology, long battery life
- Waterproof grade: IP20

Safety & Warnings

- This device contains AAA batteries that shall be stored and disposed properly.
- DO NOT expose the device to moisture.

Pair with RF+Bluetooth receiver

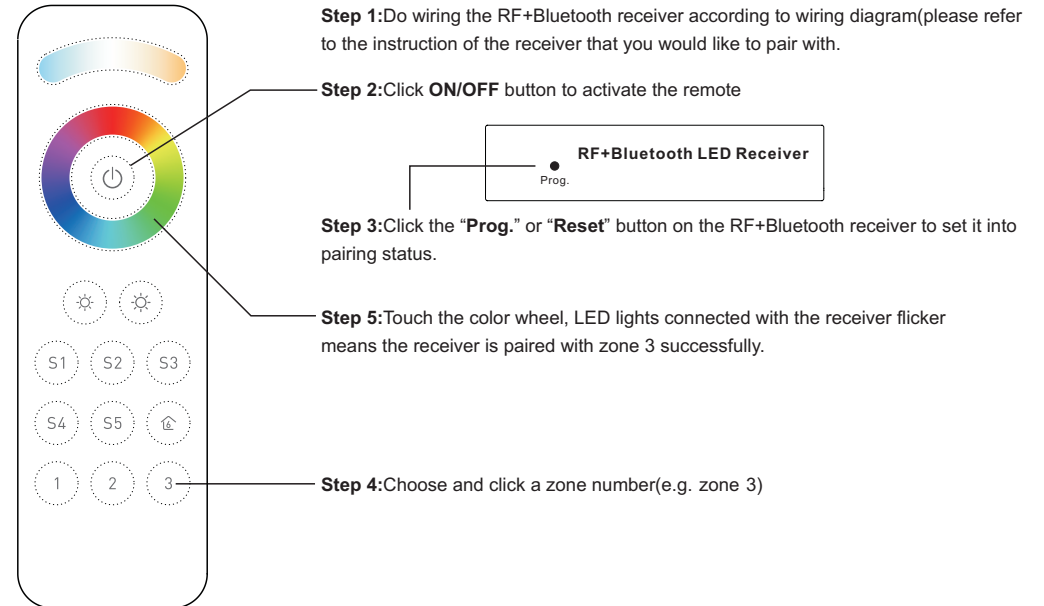

Keep short pressing the button  to get the 6 preset RGB running modes as follows:

1. R fade out -> G fade out -> R fade in -> G fade in -> B fade out -> R fade out, cycle
2. R fade out -> R fade in -> R fade out, cycle
3. G fade out -> G fade in -> G fade out, cycle
4. B fade out -> B fade in -> B fade out, cycle
5. R+B fade out -> R+B fade in -> R+B fade out, cycle
6. R+G+B fade out -> R+G+B fade in -> R+G+B fade out, cycle